

## NATURE MIRAI Area Map

Kin Town features numerous locations that reflect the history of Ryukyu and foreign cultures. It also offers convenient access from the nearby expressway interchange.

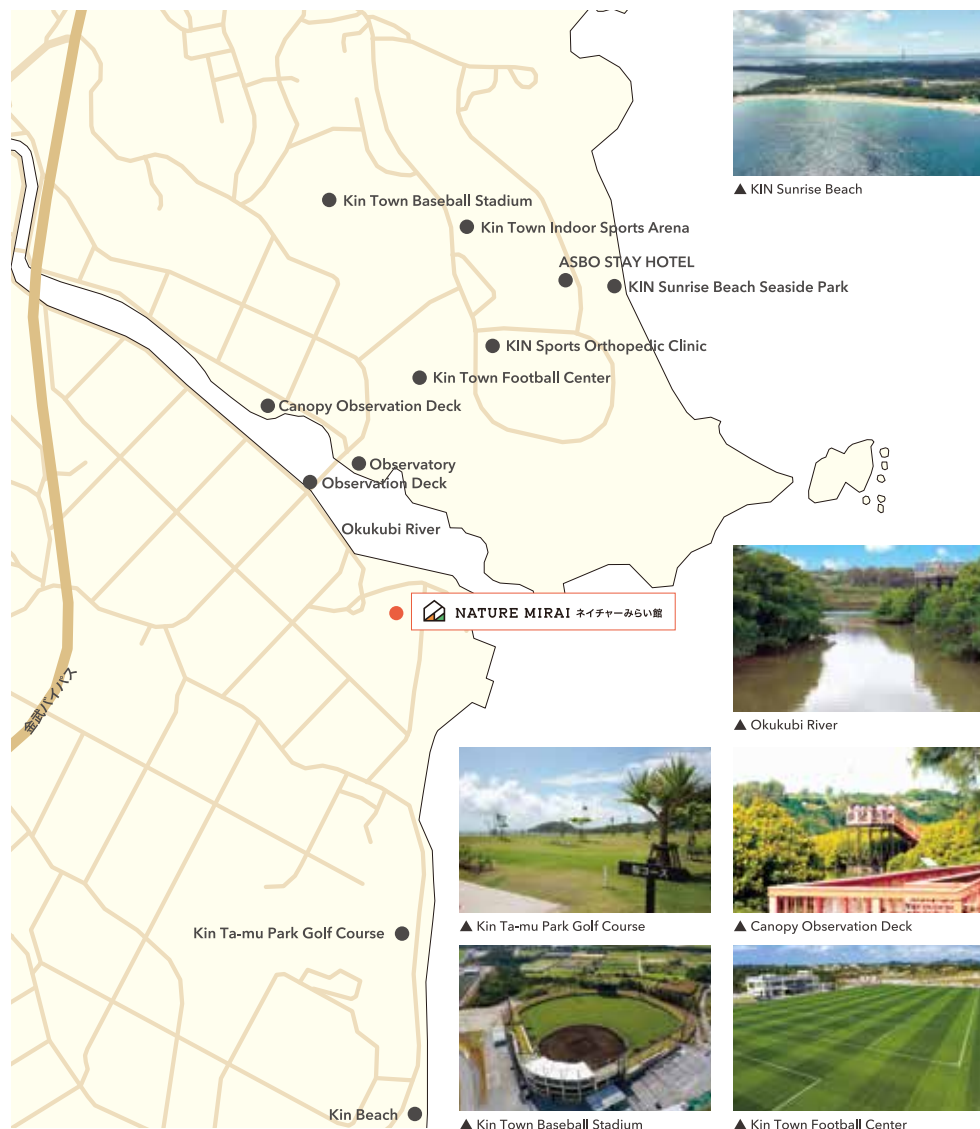

▲ KIN Sunrise Beach



▲ Okukubi River



▲ Canopy Observation Deck



▲ Kin Ta-mu Park Golf Course



▲ Kin Town Baseball Stadium



▲ Kin Town Football Center

# NATURE MIRAI - Guidebook

Collector's Edition

Welcome to NATURE MIRAI!



Reservations and Inquires: Reservations can be made 3 months in advance



**NATURE MIRAI** ネイチャーみらい館

11818-2 Kin, Kin-cho, Kunigami-gun, Okinawa Prefecture, 904-1201

☎ 098-968-6117 Reservations / 9:00 ~ 17:00



Website



LINE



Instagram



**NATURE MIRAI** ネイチャーみらい館





## CAMP P.5-6

### Best camping on earth! Go camping in nature

The campsite is located at the mouth of the Okukubi River, where mangroves inhabit, and is surrounded by *Casuarina equisetifolia* trees planted for wind protection. At night, the campsite offers a starry sky, the sounds of insects, and the calming river.



## COTTAGE P.7-8

### The Ryukyu red-roof cottages, set against the blue sky

The Ryukyu red-roof cottages symbolize NATURE MIRAI, reflecting the Okinawan culture through the vivid contrast between the blue sky and the vermillion tiles. The cottages are gently illuminated at night to blend with the natural surroundings.



## ACTIVITIES P.9-10

### Engaging in activities is the best way to learn!

Engaging with nature, interacting with people, and witnessing culture and history firsthand are the most valuable forms of learning. At NATURE MIRAI, we provide an array of experiential programs.



## Coworking P.12

### A work environment that allows for rejuvenation!

Working in a coworking space with a changed environment can boost your focus, creativity, and offer a refreshing experience. Strive for increased productivity in the natural setting of Kin Town!

## BBQ • Buffet P.11

### Savor Okinawan ingredients in nature!

Feeling the sound of the ocean and the breeze under the sky surrounded by nature and savoring the delicious smell of food being grilled with your nose is the best part of barbecuing. We offer several set menus that allow you to taste Okinawan ingredients.



## 3 factors behind NATURE MIRAI's popularity!



### Point 1 Convenient location & accessibility

You'll arrive in about 10 minutes after exiting the highway, making it easy to enjoy outdoor activities.



### Point 2 Reasonable prices

Facility usage fees are very reasonable compared to other outdoor facilities.



### Point 3 Staff on-site

The facility is staffed 24 hours a day, so you can feel safe even at night.



# NATURE MIRAI Map

This is an outdoor accommodation facility surrounded by paddy fields, rivers, and the sea. With its comprehensive facilities and rental equipment, even families with children can enjoy themselves.



Restrooms



Washing Area



炭捨 Charcoal Disposal Area



Shower Room



花火 Fireworks-permitted Area



Parking Lot

Large Buses: 3  
Standard Passenger Cars: 61  
Handicap Accessible Vehicles: 2



## CAMP

### Best camps on earth! Go camping in nature

The campsite borders both the Okukubi River and the sea. It's surrounded by Casuarina equisetifolia trees and a variety of plants and creatures. Camping here lets you seamlessly become one with nature, as if your lodging is one with the Earth. Whether you're a casual camper or a beginner, we provide a full set of rental camping equipment for your convenience. After a fun day with family and friends, gather around the BBQ and enjoy yourselves.

#### Information

Site Fee / **3,300円~** (For day camping **2,200円~**)

Facility Usage Fees / Adults (Middle school students and above) **220円**  
Children (3years old to Elementary school students) **110円**

Hours of use / Check-In: From 12:00 PM Check-Out: 10:00 AM  
(For extended plans, check-out is at 3:00 PM)  
Day Camp: Check-out is at 6:00 PM (same day)

Sections / 72 total / Each section is approx. 7m<sup>2</sup>. Capacity: 6 people  
•Riverside: 34 sections •Parking Side: 18 sections •Green Site: 20 sections

Restrooms / 3 each for men and women

Shower / Heated shower rooms for a fee (5 min.)

**Reservations can be made for BBQ and rental equipment.** P.11

We have camping sets (4 types) so that even beginners can easily enjoy camping. Please refer to the separate Camping Guidebook.



**Nature-Focused Set**  
Rental Fee / 18,000円



**Empty-Handed Camping Set**  
Rental Fee / 9,000円



#### Rules & Manners

Please take your garbage home with you. You can purchase designated Kin Town garbage bags at the store.

As a general rule, you can place one 4-5 person tent and a solo tent in each section, or two tarp. Cancellation fees apply from 30 days prior to the reservation date. For more details, please inquire.

#### Campsite

#### Riverside Area

It's a campsite surrounded by Casuarina equisetifolia trees, facing the Okukubi River and the sea. There are 4 washing areas.



#### Parking Side Area

This camp area is less affected by the wind. It is convenient for unloading luggage as the parking lot is nearby.



#### Green Area

Welcome to the Community Plaza Camp Area, where the plaza is located in front of the tents, allowing families to keep an eye on their children.



Site Usage Fee (Approx. 7m<sup>2</sup> / Capacity: 6 people)

Site Fee **3,300円~**

Facility Usage Fee Adult (Middle school students and above) **220円**  
Children (3 years and above) **110円**





A-type

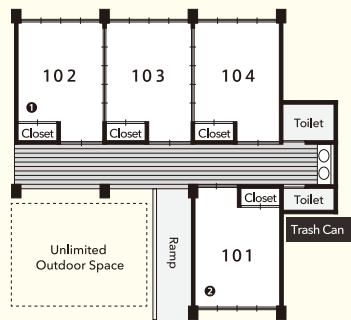

B-type

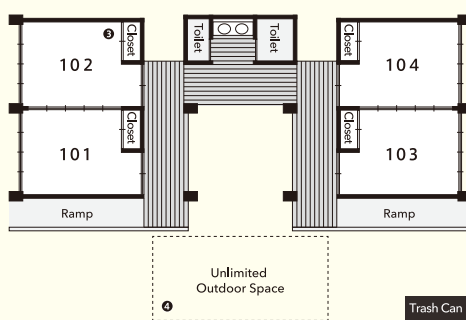

16.5m<sup>2</sup> tatami-matted room x 4, Capacity per room: 6 people

Rooms can be partitioned using sliding doors or left open to create a larger space. Guests can enjoy BBQ or relax in the unlimited outdoor space in front of the room. Each building is equipped with a ramp, making it wheelchair-accessible. Please note that there is no sleepwear provided, so please bring your own.

## COTTAGE

### The Ryukyu red-roof cottages, set against the blue sky

The Ryukyu red-roof cottages provide a lavish setting amidst green lawns. Each room is divided by sliding doors; you can open them to create a larger space. The unlimited outdoor space is perfect for BBQs and for unwinding with family and friends. In addition, guests staying at the cottage can use the attached bathhouse (separate for men and women) for free.

#### Information Free Wi-Fi

- Usage Fee / 1 building **42,900円**~ private room **13,200円**~
- Hours of use / Check-In: From 3:00 PM Check-Out: 11:00 AM
- Capacity / Capacity per room: 6 (1 building: 4 rooms, 24 people)  
Maximum accommodation capacity: 5 buildings, 120 people
- Washbasins / 2 locations per cottage
- Restrooms / 1 each for men and women
- Other / Bedding, air conditioning/heating, TV, small refrigerator, electric kettle, hair dryer
- Bathhouse / You can use the bathhouse in the separate building for free. (6:00 PM - 12:00 AM)  
You can use the private shower rooms in the separate building for a fee.

**Reservations can be made for BBQ, buffets, and rental equipment.** P.11  
You can enjoy the outdoors comfortably, even with small children.  
Please also make a reservation for BBQ and rental equipment.



#### Rules & Manners

Before disposing of your trash in the garbage cans, please purchase designated Kin Town garbage bags from the store.  
Towels are not provided in the room and bathing area.  
Amenities are available for a fee.  
Cancellation fees apply from 30 days prior to the reservation date. For more details, please inquire.



## ACTIVITIES

### Engaging in activities is the best way to learn!

Life's most valuable form of education comes from connecting with nature, people, history, and culture. At NATURE MIRAI, we provide a range of options suitable for both children and adults. These include engaging in natural activities like Mangrove/Canoe Adventures and Rice Field Play and immersive cultural experiences that allow you to delve into Okinawa's rich heritage.

#### Recommended Activities

### Mangrove/Canoe Adventures

The estuary of the Okukubi River, which flows beside NATURE MIRAI, is home to mangroves such as those called in Japanese Ohirugi, Mehirugi, and Yaeyama Hirugi. Due to its role as a habitat for diverse organisms, it has been designated as an important wetland in Japan.



#### Daytime Canoe Ride

##### 1-hour course (for prefectural residents only)

Fees / Adult (Middle school students and above) **2,750円**  
Children (3 years old to Elementary school students) **2,200円**  
Infants (2 years old) **Free**

Time required / Approx. 60 min.  
Suitable for / 2 years old and above

##### 2-hour course

Fees / Adult (Middle school students and above) **4,950円**  
Children (3 years old to Elementary school students) **3,850円**  
Infants (2 years old) **1,100円**

Time required / Approx. 120 min.  
Suitable for / 2 years old and above

#### Nighttime Canoe Ride

##### 1-hour course

Fees / Adult (Middle school students and above) **4,400円**  
Children (Elementary school students and above) **3,300円**

Time required / Approx. 60 min.  
Suitable for / Elementary school students and above

##### 2-hour course

Fees / Adult (Middle school students and above) **6,600円**  
Children (Elementary school students and above) **5,500円**

Time required / Approx. 120 min.  
Suitable for / Elementary school students and above

#### Reservation Notes

Please make reservations in advance. Same-day reservations are subject to availability. All prices include tax.

When making a reservation, please verify the start time, as it might change based on the tide's ebb and flow. Please bring a hat, towel, change of clothes, and sandals. Please contact us for information about group reservations. A decision to cancel due to weather conditions may be made just prior to the start of the activity.



### Rice Field Play

Fees / **700円**  
Time required / Approx. 60 min.  
Suitable for / 2 years old and above  
Please wear clothes you don't mind getting dirty.



### Bike Rentals

Fees / Regular bicycle **500円**  
E-BIKE (Electric bicycle) **800円**  
Time required / Approx. 60 min.  
Suitable for / 2 years old and above  
Same-day reservations.



### Mangrove Observation

Fees / **1,650円**  
Time required / Approx. 60 min.  
Suitable for / 3 years old and above

As the tour will be on foot, please take precautions against UV rays during the summer and cold weather during the winter.



### Shisa (Okinawan Lion) Coloring

Fees / **2,200円**  
Time required / Approx. 90 min.  
Suitable for / 3 years old and above  
This activity is limited to one Shisa set (male and female) per person.



### Island Sandal Art

Fees / **2,200円**  
Time required / Approx. 120 min.  
Suitable for / Elementary school students and above  
Children must join the activity accompanied by a parent/guardian, as blades will be used.



### Photo Frame Art

Fees / **1,650円**  
Time required / Approx. 60 min.  
Suitable for / 3 years old and above  
Children must join the activity accompanied by a parent/guardian, as hot glue guns will be used.

#### Reservation / Notes

Please make reservations in advance. Same-day reservations are subject to availability. All prices include tax. Please contact us for information about group reservations. Bicycle rentals are available for same-day registration only.



## BBQ / Buffet

### Savor Okinawan ingredients in nature!

Eating a meal surrounded by nature under the open sky is exceptional. Our staff has carefully selected ingredients and prepared several set menus for your selection. We also offer equipment rentals, including grills and gas stands, so even beginners can enjoy BBQ.

#### BBQ Set

- Seasonings, plates, disposable chopsticks, paper towels, toothpicks, oil, and other consumables are included in the set.
- You can also order just BBQ.
- Rice is not included in the BBQ set, so please order it as an option.

#### Beef Loin Set

**Adult Set** ● Beef loin (180g)  
● 3 yakitori (skewered chicken)  
● 2 sausages ● vegetables (80g) **1,980 ¥**

**Child Set** ● Beef loin (120g)  
● 2 yakitori (skewered chicken)  
● 2 sausages ● vegetables (80g) **1,650 ¥**

**Infant Set** ● Beef loin (180g)  
● 1 yakitori (skewered chicken)  
● 1 sausage ● vegetables (50g) **1,430 ¥**

#### Sirloin Set

**Adult Set** ● Beef sirloin (180g)  
● 3 yakitori (skewered chicken)  
● 2 sausages ● vegetables (80g) **2,200 ¥**

#### Kalbi (Short Ribs) Set

**Adult Set** ● Pork short ribs (100g) ● Beef loin (180g)  
● 3 yakitori (skewered chicken)  
● 2 sausages ● vegetables (80g) **2,530 ¥**

**Option menu** ● 1 serving of rice **220 ¥**  
● Yakisoba (500g) **550 ¥**

#### Notes about the barbecue

- Reservations for BBQ must be made 3 days in advance.
- Same-day reservations are not available.
- After ingredients have been ordered, we are unable to process cancellations.
- A minimum of two sets of ingredients must be ordered.

Use one gas stand for free with ten or more orders!

We provide rental services at the following rates for groups with fewer than 10 guests.



● BBQ Grill **1,320 ¥**  
● Gas Stand **3,300 ¥**

#### Buffet



A buffet is available in the seminar building (dining hall). Typically, reservations are accepted for 10 or more people, but depending on availability, it may be possible to accommodate smaller groups. Please inform us of your order, the number of people, and allergies at least one week prior to your visit.

Breakfast	/ Adult	<b>1,100 ¥</b>	Child	<b>770 ¥</b>	Infant	<b>550 ¥</b>
Lunch	/ Adult	<b>1,320 ¥</b>	Child	<b>990 ¥</b>	Infant	<b>660 ¥</b>
Dinner	/ Adult	<b>1,980 ¥</b>	Child	<b>1,100 ¥</b>	Infant	<b>880 ¥</b>



## Coworking

### A work environment that allows for rejuvenation!

Working in a coworking space with a changed environment can boost your focus, creativity, and offer a refreshing experience. The space can be used by individuals and for corporate training meetings. Strive for increased productivity in the natural setting of Kin Town!

#### Information Free Wi-Fi

Fees / Coworking Space **1,100 ¥** (short use: 3 hours)  
**3,300 ¥** (3 hours or more per day)

Meeting Room / Capacity: 10 people  
(with video conferencing system) **3,300 ¥** (per hour)

All spaces reserved **6,600 ¥** (per hour)

**Guest Discount** **880 ¥** (short use: 3 hours)  
**2,640 ¥** (3 hours or more per day)

**Guest Discount** **2,640 ¥** (per hour)

**Guest Discount** **5,280 ¥** (per hour)

Hours of use / 9:00 - 21:00

Number of Seats / Coworking Space: 11 seats / Conference Room: 10 seats

Other / Copy machine, power outlets at each table



#### Reservation Notes

Advance reservation All prices include tax.  
Please refrain from bringing your own food. Beverages are allowed.







## Piloti

This large, open space can be utilized for a variety of purposes, including group gatherings and BBQs. Individuals can also use it to seek shelter from the scorching sun or rain.

Fees / Adult: **550円** Child: **330円**  
 Education/Welfare-related services: Flat rate **220円**  
 Wooden tables are provided according to the number of people.  
 The above rates are for 6 hours or less.

Hours of use / 9:00 - 21:00

Facility / Approx. 500 people

Examples of use / Gathering place for activities, BBQ venue, etc.



## Community Building

The spacious 66m<sup>2</sup> tatami-matted room overlooking the lawn and a wooden deck connecting the indoor and outdoor areas can be used for group events.

Fee / **3,300円** (1 hour)

Hours of use / 9:00 - 21:00

Facility / Approx. 66m<sup>2</sup>

Examples of use / Indoor Activity Venue



## Seminar Building (Dining Hall)

It can be used for gatherings and serve as a venue for group dining. Depending on the number of reservations, it may also be used as a venue for breakfast buffets.

Fee / **4,400円** (1 hour)

Hours of use / 9:00 - 21:00

Facility / Approx. 100 people

Examples of use / Seminar venue,  
corporate training facility, dining venue



## Audio Visual Room

The facility is fully equipped with a projector and microphones, and can be used for corporate training, educational presentations, and remote group meetings.

Fee / **3,300円** (1 hour)

Hours of use / 9:00 - 21:00

Facility / Approx. 30 people

Examples of use / Venue for workshops, seminars,  
and corporate training



## Shower Room

Camping and outdoor activities can make you break a sweat. You can also use it as a changing room.

Fees / **200円** (For 5 min.)

Hours of use / 6:00 - 24:00

Shower / 6 showers each for men and women

Amenities / Washbasin, conditioner, shampoo  
Body wash, hair dryer

The key for the provided lockers can be rented for JPY 200 each at the office.



## Bathhouse

Guests staying in the cottage can use the bathhouse (separated by gender).

Hours of use / (Morning) 6:00 AM - 8:00 AM  
(Afternoon) 6:00 PM - 12:00 AM  
Please consult with us about bathing hours.

Facility / 12 each for men and women

Amenities / Washbasin, conditioner, shampoo  
Body wash, hair dryer

We have an outdoor laundromat, including dryers. (available 24 hours)  
Please note that there are no towels provided in the bathhouse.



## Shop

We offer camping essentials, cup noodles and snacks for sale. We also have charcoal and firewood for BBQs.

Hours of use / 9:00 - 21:00

Products / Drinks, snacks, camping equipment,  
amenities, cup noodles, etc.





## Rental Items

We offer a variety of rental equipment perfect for beginners

We offer a variety of convenient and comfortable equipment for camping, cottages, workshops, and training, ranging from beginner to high-end gear. All prices include tax.

### Tents, tarps, tables, chairs



Spectacular openness, top-of-the-line model!  
Enjoy camping comfortably with a spacious living room!

**Cocoon Tent** Includes Setup/Removal  
(Approx. 670cm×Approx. 400cm×Approx. 220cm)  
**11,000円**



**Coleman Tent (with ground sheet)**  
(Approx. 270cm×Approx. 270cm×Approx. 170cm)  
**2,200円**



**Sleeping Bag**  
**660円**

**Mat**  
**330円**



**Coleman Tarp**  
(Approx. 360cm×Approx. 360cm×Approx. 265cm)  
**2,200円**



**Snow Peak Tent (with ground sheet)**  
(Approx. 530cm×Approx. 300cm×Approx. 150cm)  
**2,200円**



**Camp Outdoor Table**  
**Small 550円**  
(Approx. 120cm×Approx. 60cm×Approx. 70cm)  
**Large 880円**  
(Approx. 180cm×Approx. 75cm×Approx. 72cm)



**Bamboo Table**  
(Approx. 100cm×Approx. 70cm)  
3 Height Levels: 48cm/58cm/70cm  
**880円**



**Wooden Table**  
(Seating for 6-8 people)  
**2,200円**



**Hammock**  
**1,650円**

Combine it with a two-burner stove for a convenient outdoor kitchen!



**Kitchen Table**  
(Approx. 150cm×Approx. 60cm×Approx. 80cm)  
**1,650円**



**Table Set**  
**1,650円**



**Leisure Chair**  
**330円**

Reclining is also possible!  
Comfortable outdoor chair



**High-Back Chair**  
**880円**



**High-Spec Lantern**  
**880円**



**Lantern**  
**550円**



**Lantern Stand**  
**550円**

### Stoves & Cookware

A two-burner stove is convenient for cooking!



**BBQ Grill**  
(Griddle, Tongs, Spatula)  
(Approx. 65cm×Approx. 30cm)  
**1,320円**



**Gas Stand Set**  
(Approx. 50cm×Approx. 50cm)  
**3,300円**



**Portable Stove**  
**550円**



**Two-Burner Stove**  
(Approx. 50cm×Approx. 30cm)  
**1,650円**  
Gas can be purchased at the store



**Cookware Set**  
For 4 people **1,100円** For 8 people **1,650円**



**Dutch Oven**  
**1,650円**



**Tableware (for 4 people)**  
**1,100円**



**Hot Sandwich Maker**  
**550円**



**Knife and Cutting Board Set**  
**330円**



**Frying Pan**  
**330円**



**Large Pot**  
**550円**



**Commercial Rice Cooker**  
**1,100円**

## Bonfire & Convenient Items



**Bonfire Pit (with fireproof sheet)**  
1,100円

Firewood can be purchased at the store



**Log Splitter**  
550円



**Starter**  
330円

Convenient for lighting, air conditioning power supply in tents, charging smartphones, etc!



**Portable Power Source** 4,400円  
(Up to 1000W)



**Keeper**  
Small 550円 Large 880円



**Cooler Box**  
(Approx. 55cm×Approx. 35cm×Approx. 40cm※30L) Small 550円  
(Approx. 85cm×Approx. 40cm×Approx. 50cm※50L) Large 880円



**Ice Box** 2,200円

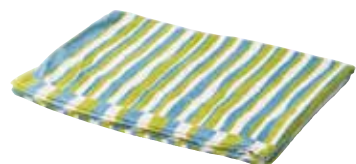

**Towel Blanket**  
550円



**Towel**  
Bath Towel 200円 Face Towel 150円



**Commercial Fans**  
550円

## For Meetings



**Portable Amplifier**  
3,300円



**Projector**  
3,300円



**Whiteboard**  
550円

### Other

**Indoor Table** 880円

**Low Table** 880円

**Round Chairs** 220円

**Large Pot Set** 3,300円

## Rules & Manners / Notes

NATURE MIRAI provides rules and manners to ensure that all visitors feel comfortable using our facilities and services.

### Campsite

- Fees are paid in advance. Please complete the check-in process before entering the designated area.
- Each section is about 7m<sup>2</sup> and can accommodate a tent for 4-5 people and a solo tent or 2 tarps.
- Each section has a maximum capacity of 6 people.
- Open fires are prohibited. Please be sure to use a bonfire pit and fireproof sheet.
- As a rule, garbage must be taken home, but it can also be collected for a fee.

### Cottage

- Each building has a capacity of 24 people, with each room accommodating up to 6 people.
- The bathhouse is located in the annex.
- Fireworks are prohibited near the cottages. Please enjoy them in the designated area.
- Equipment related to handling fire is provided for rental at our facility (such as grills and gas stands). Please do not bring your own.
- Please remove the sheets and covers from the used futon, mattress, and pillow, and place them in the collection bag in the outer corridor.

### Activities

- Activities must be paid for in advance.
- The activity may be cancelled mid-way due to inclement weather or other reasons.  
Please note that refunds will not be provided in such cases.  
(In some cases, the decision to cancel due to inclement weather may be made just before the start of the activity.)

### Common to all facilities

- Smoking in the facility is permitted in designated areas with ashtrays.
- Pets are not allowed in the facility.
- Customers who wish to use fireworks should enjoy them in designated areas within the facility.
- Please make sure that communal areas are kept clean.
- Please adhere to the check-in and check-out times during your stay.
- Out of respect for fellow guests, kindly keep noise levels to a minimum after 9:00 PM.

### Cancellation policy

Cancellation date	15-30 days prior	4-14 days prior	3 days to the day before	On the day
Cancellation fee	20%	50%	80%	100%

### Notes

Customers are responsible for picking up, setting up, taking down, and returning any items rented at the campsite. Please refrain from using rental items for purposes other than their intended use. In the unlikely event of damage or missing items, you may be requested to cover the full replacement cost.